

DATA SHEET V120F

SPRING MOUNT

M20 RANGE

OPEN COIL

THIS IS NOT A STAND ALONE DOCUMENT AND UNLESS REFERRED TO IN A CERTIFIED EQUIPMENT SCHEDULE IS SUBJECT TO REVISION WITHOUT NOTICE.

CAPACITY

TYPE	COLOUR CODE	LOAD * Kg	DEFLECTION * mm
21	BROWN	206	61
22	GREEN	274	54
23	WHITE	366	51
24	BLUE	497	49
25	ORANGE	646	43
26	PURPLE	958	38
26N	PURPLE/GOLD	1330	38

*IMPORTANT : VALUES SHOWN ARE MAXIMUM WITH SPRING IN SOLID CONDITION. RECOMMENDED OVERLOAD CAPACITY IS 50%.

DIMENSIONS

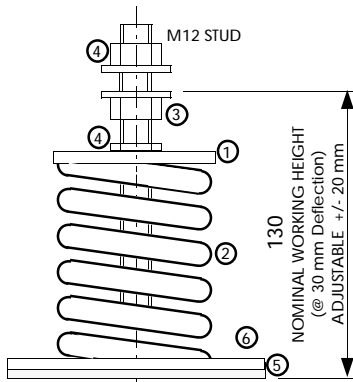

ELEVATION

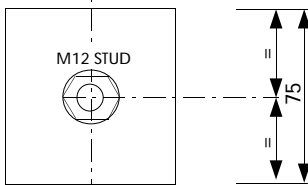

PRESSURE PLATE

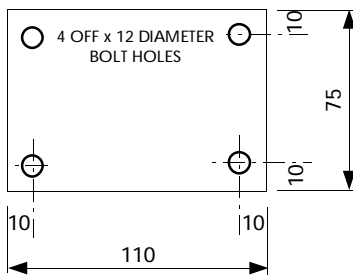

BASE PLATE

COMPONENTS

1. SPRING PRESSURE PLATE.
2. COLOUR CODED HIGH DEFLECTION STEEL SPRING (TYPE N HAS NESTED SPRING).
3. ADJUSTING NUT. INSTALLERS TO LUBRICATE WITH FREEING OIL (WD40)
4. LOCKING NUT.
5. HIGH FREQUENCY ISOLATION PAD.
6. 12 mm HOLDING DOWN BOLT HOLES.

FINISH

PASSIVATED ZINC PLATING TO METAL COMPONENTS.

POLYESTER COATING TO SPRING (COLOUR CODED).

SUITABLE FOR USE IN NON-CORROSIVE EXTERNAL APPLICATIONS.

FEATURES

- OPEN COIL
- HIGH LOAD CAPACITY
- HIGH DEFLECTION
- ALL STEEL CONSTRUCTION
- HIGH FREQUENCY ISOLATION
- ZINC PLATED COMPONENTS
- POWDER COATED SPRING
- COLOUR CODED



LOAD/DEFLECTION GRAPH

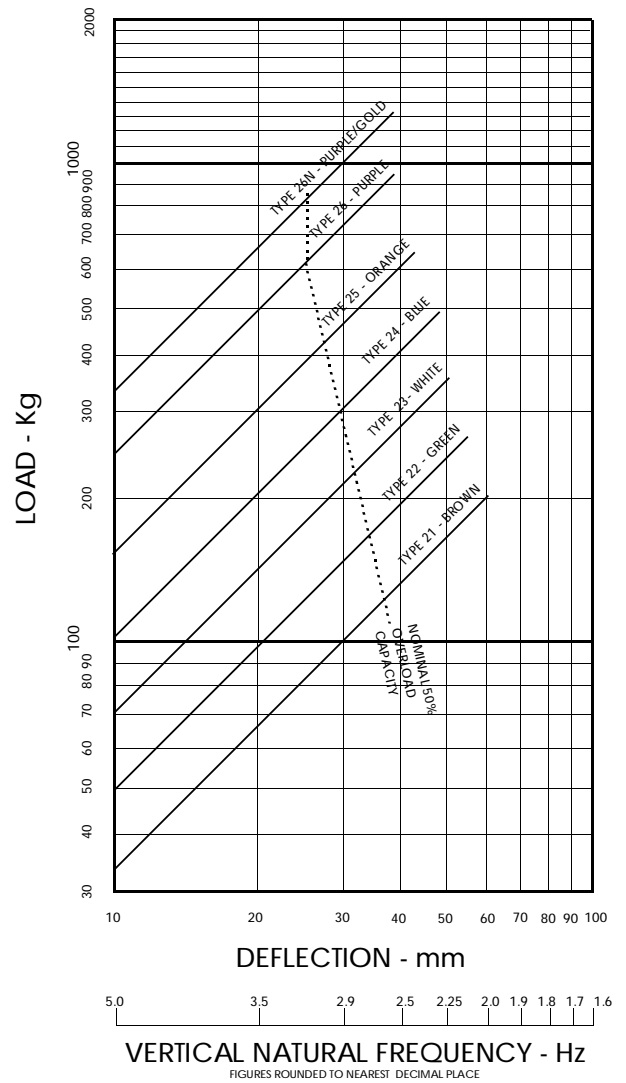

NOTES

THIS DATA SHEET IS TO BE READ IN CONJUNCTION WITH THE EQUIPMENT SCHEDULE.

THE SPRING WILL NEED ADJUSTING AFTER INSTALLATION.

HOLDING DOWN BOLTS TO BE SUPPLIED AND FITTED BY OTHERS.

SUITABLE FOR USE IN NON-CORROSIVE EXTERNAL APPLICATIONS.

SUFFIX

M(-) - OPEN COIL SPRING MOUNT

SP - SPECIAL CONSTRUCTION. SEE EQUIPMENT SCHEDULE FOR DETAILS